

The razor's edge: $\frac{1}{1000}$ mm

A space of a thousandth of a millimeter is so small that you naturally can't see it at all with the naked eye. Such are the tolerances allowed in making Genuine VW Spare Parts. The instruments that do this microscopic measuring are veritable miracles of precision. Obviously such equipment costs a lot of money; but to justify the confidence of our customers we have a whole series of these appliances at work in the Volkswagen plant, continually and carefully checking the accuracy of Genuine VW Spare Parts.

Genuine VW Spare Parts — rigidly factory inspected.



Genuine VW Spare Parts rigidly factory

inspected

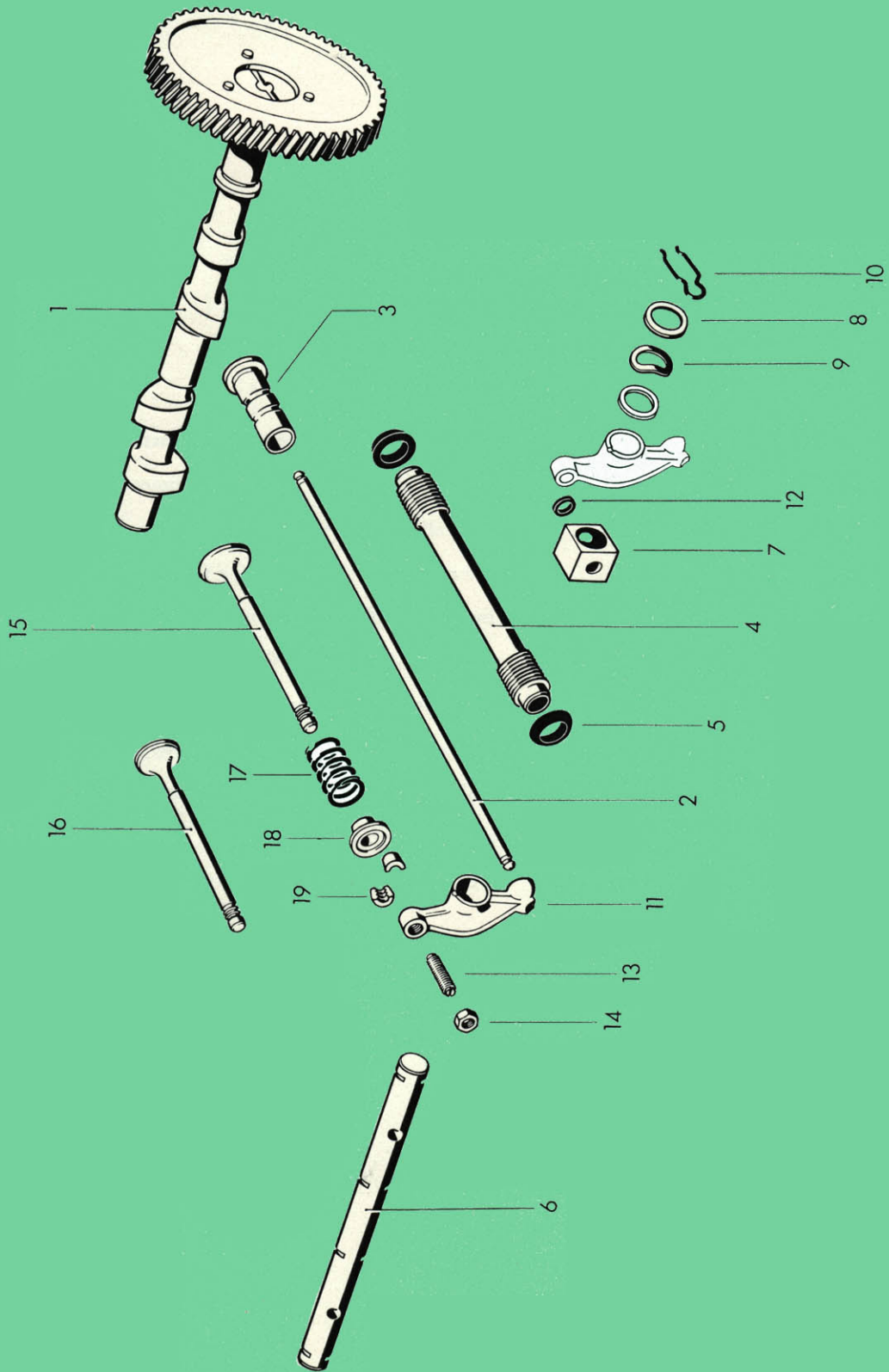

illustration 3

Key No.	Part No.	Description	Quantity	Type and model
CAMSHAFT, VALVES				
15/63	1	113 109 015 D	Camshaft with timing gear - 3	×
15/63	-	113 109 017 D	Camshaft with timing gear - 2	×
7/62	-	113 109 019 D	Camshaft with timing gear - 1	×
7/62	-	113 109 021 D	Camshaft with timing gear ± 0	×
7/62	-	113 109 023 D	Camshaft with timing gear + 1	×
7/62	-	113 109 025 D	Camshaft with timing gear + 2	×
7/62	-	113 109 027 D	Camshaft with timing gear + 3	×
7/62	-	113 109 029 D	Camshaft with timing gear + 4	×
7/62	-	113 109 031 D	Camshaft with timing gear + 5	×
7/62	-	113 109 033 D	Camshaft with timing gear + 6	×
7/62	-	113 109 035 D	Camshaft with timing gear + 7	×
	-	311 109 301	Push rod - Valve	8
			up to Engine No. June 1963	
15/63	2	311 109 301 B	Push rod with knurling - Valve	8
			from Engine No. July 1963	
7/62	3	113 109 309 C	Cam follower	8
	4	311 109 335	Tube - Push rod	8
	5	113 109 345 A	Sealing washer - Push rod tube	16
	6	113 109 407	Rocker shaft	2
	-	113 109 427	Bearing support - Rocker shaft	4
			up to Engine No. June 1963	

735 316 20

Printed in Germany

Type 3 Supplement 15/63

Key No.	Part No.	Description	Quantity	Type and model	
15/63	7	113 109 427 A	Bearing support (market with "Top") – Rocker shaft from Engine No. July 1963	4	
	8	113 109 435	Thrust washer – Rocker arm	16	
	9	113 109 437	Spring washer – Rocker arm	8	
	10	113 109 439	Spring clip – Rocker shaft	8	
	–	311 109 443	Rocker arm with one rib up to Engine No. June 1963	8	
15/63	11	311 109 443 A	Rocker arm with two ribs from Engine No. July 1963	8	
	12	113 109 449 A	Sealing washer – Stud 113 101 397 A	4	
	13	111 109 451	Adjusting screw – Valve	8	
	14	N 11 152 1	Nut. hex. M 8×1 DIN 936	8	
	15	311 109 601	Intake valve 35.6 mm dia. (marked „S”)	4	
	–	311 109 611 B	Exhaust valve 31 mm dia. up to Engine No. 65 745	4	
7/62	16	311 109 611 D	Exhaust valve 32 m dia. from Engine No. 65 746	4	
7/62	–	113 109 621	Cap – Valve stem	8	
7/62	17	113 109 623 A	Spring – Valve	8	
	18	113 109 641 A	Seat – Valve spring	8	
	19	113 109 651 A	Cotter, split – Valve	16	