



If you think

something could be done better than it is in the parts stockroom, thoroughly consider all the factors involved. If you are still sure your idea will benefit the stockroom (and thus yourself), there is just one thing to do: take it to the boss.



Genuine VW Spare Parts rigidly factory inspected

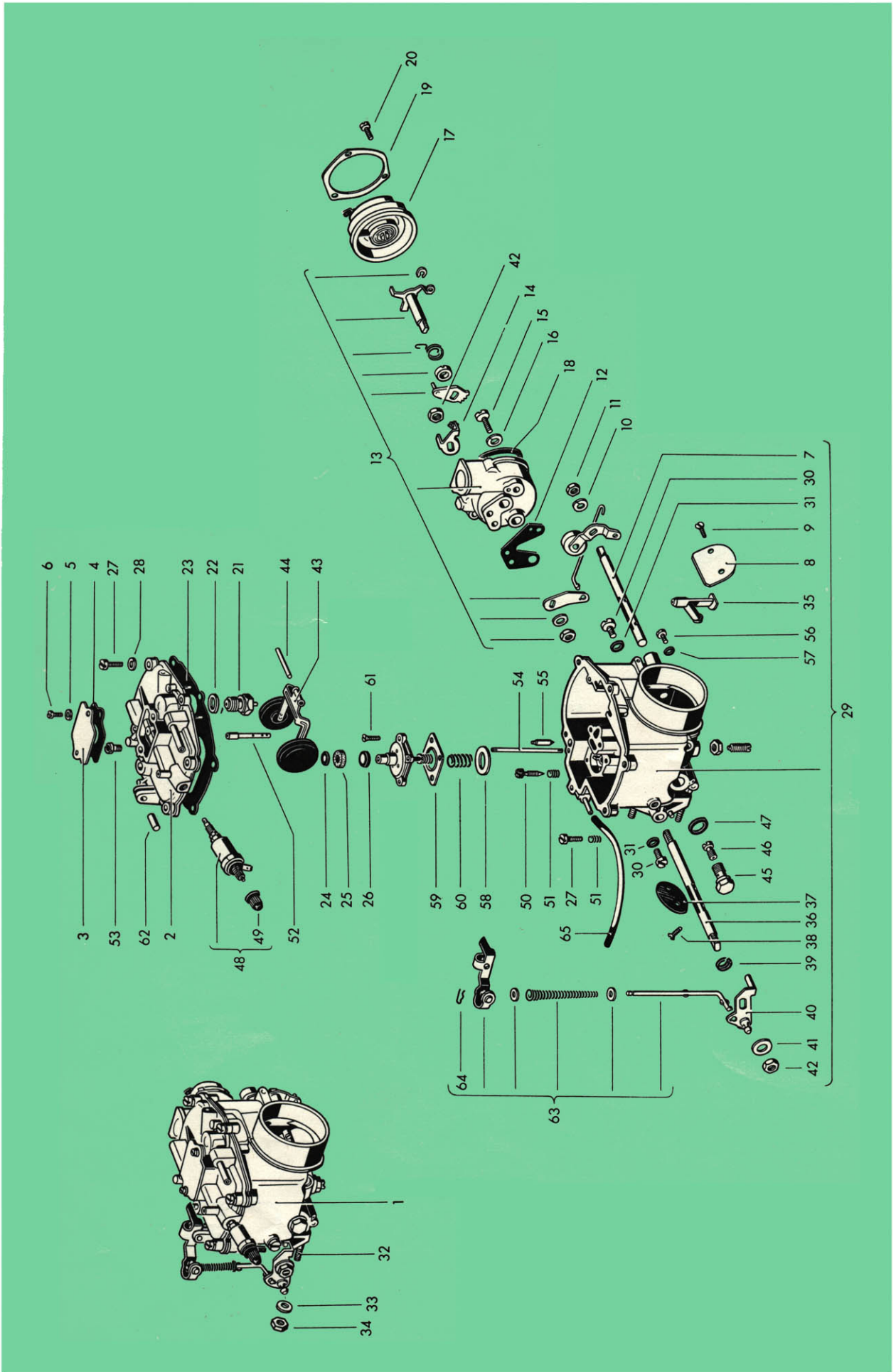

illustration 7

Key No.	Part No.	Description	Quantity	Type and model
CARBURETOR 32 PHN				
14/63	1	311 129 025 D Carburetor 32 PHN – 1	1	
3/62	2	311 129 109 A Cover – Carburetor for carburetor 311 129 025/B	1	
7/62	–	311 129 109 B Cover – Carburetor for carburetor 311 129 025 A/D	1	
	3	311 129 117 Inspection plate – Carburetor cover	1	
	4	311 129 119 Gasket – Inspection cover	1	
	5	N 12 004 1 Lock washer B 4 DIN 127	2	
5/62	6	311 129 123 Screw, cheese head – Inspection plate	2	
	7	311 129 131 Choke shaft	1	
	8	311 129 135 Choke valve	1	
	9	113 129 149 Screw, countersunk raised head M 3×6 – Choke valve	2	
	10	N 12 006 2 Lock washer B 6 DIN 127 galvanized	1	
	11	113 129 157 Nut, hex. – Choke	1	
	12	311 129 159 Sealing plate – Choke housing	1	
	13	311 129 161 Choke housing with levers	1	
	14	311 129 163 Stop lever – Fast idle cam	1	
	15	311 129 189 Screw, cheese head – Choke housing	2	
	16	N 12 005 1 Lock washer B 5 DIN 127 galvanized	2	
13/63	17	311 129 191 A Cover with spring and heater element	1	
	18	311 129 193 Gasket – Cover	1	
	19	311 129 199 Retaining ring – Cover	1	

Key No.	Part No.	Description	Quantity	Type and model
5/62	20	311 129 123 Screw, cheese head – Retaining ring	3	
3/62	21	111 129 201 Needle valve 1.5 mm dia.	1	
	22	111 129 213 C Sealing washer – Needle valve	1	
	23	311 129 281 Gasket between carburetor body and cover for carburetor 311 129 025/B	1	
8/62	–	311 129 281 A Gasket between carburetor body and cover	1	
5/62	24	N 11 523 3 Washer A 5.3 DIN 125 galvanized	1	
	25	311 129 285 Felt ring – Push rod	1	
	26	311 129 287 Sealing ring – Push rod	1	
	27	311 129 289 Screw, cheese head – Carburetor cover and idling stop	7	
	28	N 12 005 1 Lock washer B 5 DIN 127 galvanized	6	
	29	311 129 301 Main body – Carburetor	1	
		for carburetor 311 129 025/B		
14/63	–	311 129 301 B Main body – Carburetor	1	
		for carburetor 311 129 025 A/D		
	30	311 129 307 Plug M 6×6 – Body drillings	2	
	31	311 129 309 Gasket – Plug	2	
	32	111 129 317 Stud – Carburetor mounting	2	
3/62	33	N 12 229 1 Spring washer A 8 DIN 137 galvanized	2	
	34	N 11 008 3 Nut, hex. M 8 DIN 934 galvanized	2	
3/62	35	311 129 327 Injector tube – Carburetors 311 129 025/A/B	1	
14/63	–	311 129 327 A Atomizer – Carburetor 311 129 025 D	1	
	36	311 129 335 Shaft – Throttle	1	
	37	311 129 337 Throttle valve	1	
	38	111 129 149 B Screw, countersunk raised head 4×7 – Throttle valve	2	
	39	311 129 341 Sealing ring – Throttle valve shaft	1	
	40	311 129 343 Throttle lever	1	

Key No.	Part No.	Description	Quantity	Type and model
41	113 129 355	Lock plate – Nut, hex.	1	
42	111 129 157	Nut, hex. – Throttle valve shaft	2	
43	311 129 391	Float	1	
44	311 129 399	Pin – Float lever	1	
45	111 129 401 A	Carrier – Main jet	1	
46	311 129 405	Main jet 137.5	1	
7/62	– 311 129 405 A	Main jet 132.5	1	
14/63	– 311 129 405 B	Main jet 127.5	1	
47	111 129 409	Sealing washer – Carrier	1	
8/62	48 311 129 413 A	Electro-magnetic pilot jet g 45	1	
8/62	– 113 129 413 A	Electro-magnetic pilot jet g 50	1	
	– 311 129 417	Cap M 30 – Electro-magnetic pilot jet	1	
3/62	49 311 129 417 A	Cap M 8 – Electro-magnetic pilot jet	1	
	50 311 129 427	Volume control screw	1	
	51 111 129 429 B	Spring – Volume control screw and idling stop screw	2	
	52 311 129 433	Emulsion tube 48	1	
	53 311 129 435 A	Air correction jet 125	1	
7/62	– 311 129 435 B	Air correction jet 115	1	
	54 311 129 441	Capacity rod 3.5×57	1	
	55 311 129 443	Needle valve rod 5×19	1	
	56 311 129 445	Screw, cheese head – Pump injector tube	1	
	57 311 129 447	Sealing ring – Screw, cheese head	1	
3/62	58 311 129 449	Spacer washer – Pump for carburetors 311 129 025/A/D	1	

735 315 20

Printed in Germany

Type 3 Supplement 14/63

Key No.	Part No.	Description	Quantity	Type and model
3/62	59	311 129 451 A Diaphragm with push rod for carburetor 311 129 025	1	
8/62	-	311 129 451 C Diaphragm with push rod for carburetors 311 129 025 A/B/D	1	
	60	311 129 467 Spring - Diaphragm	1	
	61	111 129 473 Screw, countersunk raised head 4x10 - Cover ...	4	
3/62	62	311 129 479 Pin - Pump lever	1	
	-	311 129 481 Throttle connector rod - Pump up to Carburetor No. 9999	1	
3/62	63	311 129 481 A Throttle connector rod with pump lever	1	
3/62	64	311 129 489 Lock spring - Connector rod	1	
	65	113 129 491 Vacuum tube	1	