



The Volkswagen breed

must be kept pure. No matter what part you need for maintenance, it must be a Genuine VW Part, a Part with a Pedigree, in order to keep all VW owners and drivers among your contented customers.



Genuine VW Parts rigidly factory

inspected

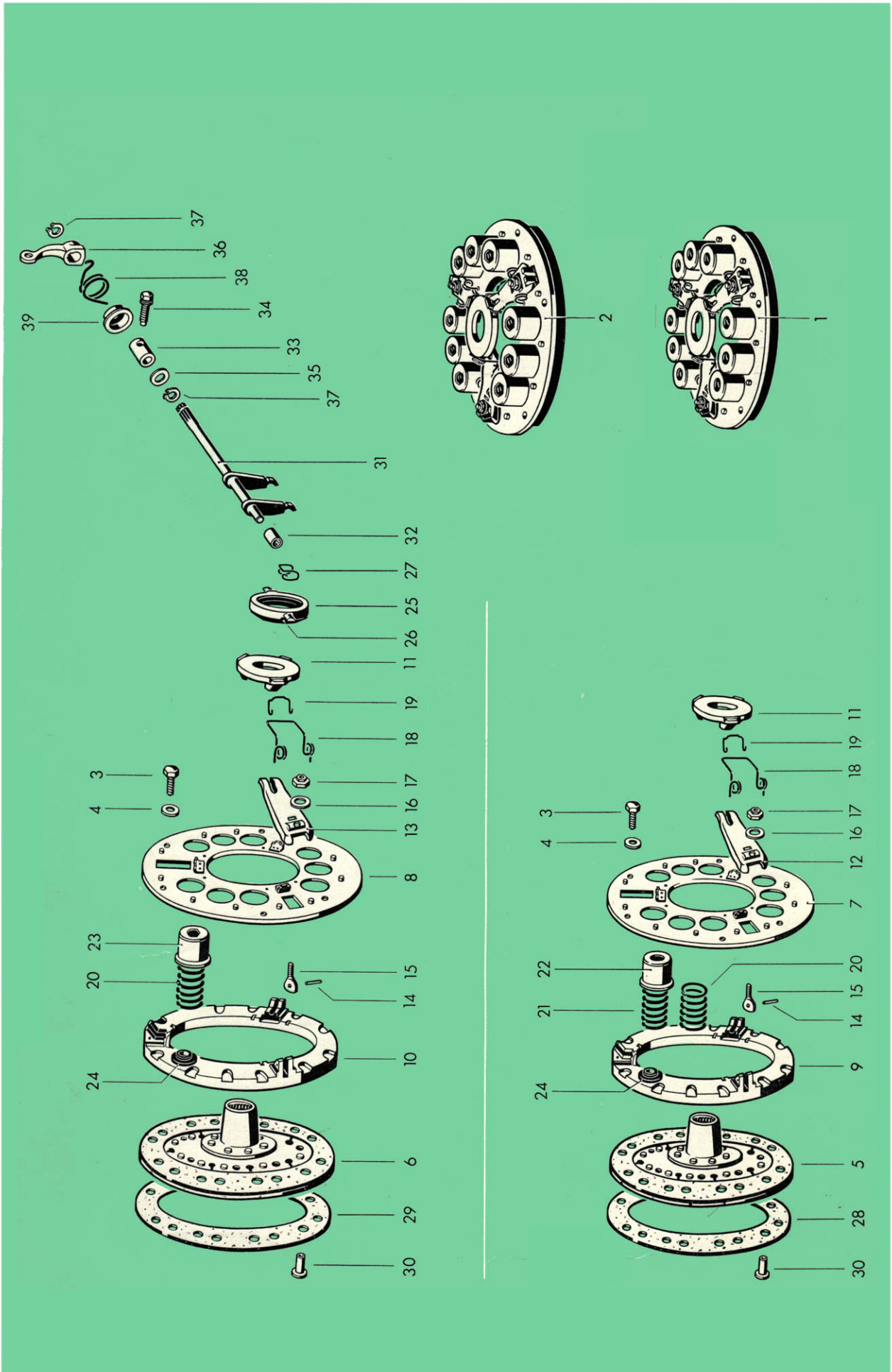

Illustration 9

Key No.	Part No.	Description	Quantity	Type and model
CLUTCH				
1	311 141 025	Clutch cover and pressure plate 180 up to Engine No. 65 745	1	
7/62 2	211 141 025 A	Clutch cover and pressure plate 200 from Engine No. 65 746	1	
3	N 10 240 1	Bolt, hex. head M 8×20 DIN 933	6	
4	N 12 228 2	Spring washer B 8 DIN 137 galvanized	6	
5	111 141 031 B	Clutch plate 180 up to Engine No. 65 745	1	
7/62 6	211 141 031	Clutch plate 200 from Engine No. 65 746	1	
7	311 141 111	Clutch cover up to Engine No. 65 745	1	
7/62 8	211 141 111	Clutch cover from Engine No. 65 746	1	
9	311 141 117	Clutch pressure plate up to Engine No. 65 745	1	
7/62 10	211 141 117	Clutch pressure plate from Engine No. 65 746	1	
11	311 141 125	Clutch release plate	1	
12	311 141 129	Clutch release lever up to Engine No. 65 745	3	
7/62 13	211 141 129	Clutch release lever from Engine No. 65 746	3	
14	311 141 131	Pin – Bolt	3	
15	311 141 133	Bolt	3	
16	311 141 135	Thrust washer – Adjusting nut	3	
17	311 141 137	Adjusting nut	3	
18	111 141 141	Return spring – Clutch release lever	3	
19	311 141 145	Spring – Clutch release plate	3	
20	311 141 151	Thrust spring (marked white) up to Engine No. 65 745 from Engine No. 65 746	3 9	

735 312 20

Printed in Germany

Type 3 Supplement 11/63

Key No.	Part No.	Description	Quantity	Type and model
21	311 141 153	Thrust spring (marked violet) up to Engine No. 65 745	6	
22	111 141 161	Cap – Clutch thrust spring (round hole) up to Engine No. 65 745	9	
7/62	23	211 141 161	Cap – Clutch thrust spring (hexagonal hole) from Engine No. 65 746	9
24	111 141 163	Seat – Clutch thrust spring	9	
2/61	25	111 141 165	Bearing – Clutch release	1
2/61	26	111 141 173	Graphite ring – Clutch release bearing	1
2/61	27	111 141 177	Retaining spring – Clutch release bearing	2
11/63	28	SP 127 D	1 set of linings 180 – Clutch plate 111 141 031 B	1
11/63	29	SP 128	1 set of linings 200 – Clutch plate 211 141 031 ..	1
30	N 13 671 1	Rivet B 5×5 DIN 7338	16	
7/62	31	113 141 701 B	Operating shaft – Clutch	1
32	113 141 711	Bush right – Operating shaft	1	
33	113 141 713	Bush left – Operating shaft	1	
34	113 311 141	Lock screw – Operating shaft bush	1	
35	113 141 717	Washer 16.1×22.5 – Operating shaft	1	
7/62	36	111 141 719 B	Clutch operating lever	1
37	N 12 416 1	Lock ring 16×1 DIN 471	2	
38	113 141 723	Return spring – Clutch operating lever	1	
39	111 141 727	Seat – Return spring	1	

Key No.	Part No.	Description	Quantity	Type and model
<p>ENGINE MOUNTING, REAR (see also Illustration 5)</p>				
-	311 199 021	Tube – Engine mounting, rear	1	
-	311 199 125	Washer – Tube	1	
-	311 199 131	Housing – Engine mounting, rear	1	
-	311 199 143	Packing – Housing	x	
-	311 199 145	Rubber mounting	1	

MAIN GROUP



Key No.	Part No.	Description	Quantity	Type and model