

MAIN GROUP



FRAME HAND LEVER SYSTEM PEDAL CLUSTER

| | Illustration |
|----------------------|--------------|
| 05 Frame | 21 |
| 07 Bumpers | 21 |
| 11 Hand lever system | 22 |
| 21 Pedal cluster | 23 |

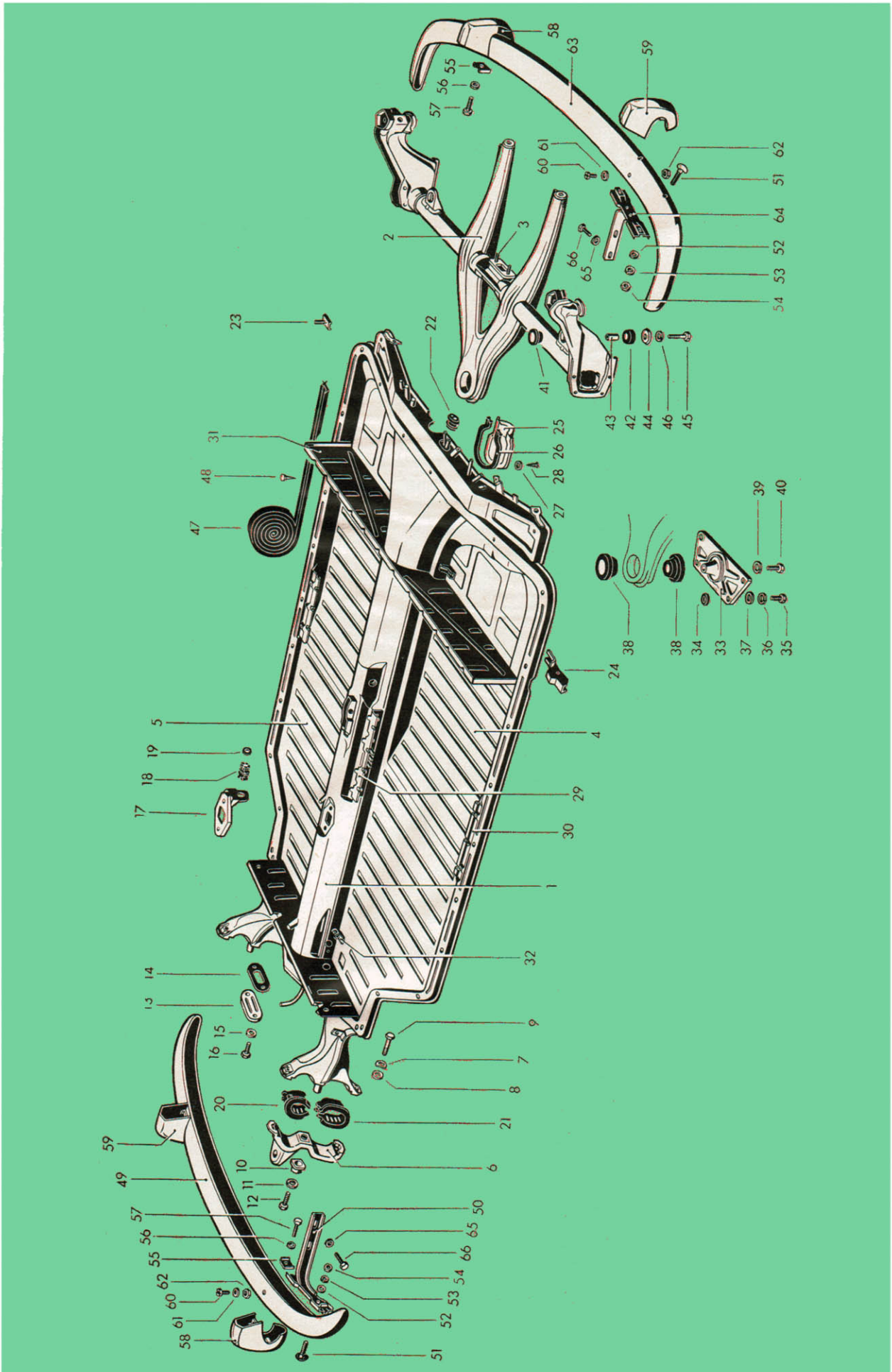

illustration 21

| Key No. | Part No. | Description | Quantity | Type and model |
|--------------|----------------------|---|----------|-----------------|
| FRAME | | | | |
| | 1 311 700 021 | Frame without sub-frame (LHD) | 1 | 311, 313 |
| 2/61 | - 312 700 021 | Frame without sub-frame (RHD) | 1 | 312, 314 |
| 2/61 | - 361 700 021 | Frame without sub-frame (LHD) | 1 | 361, 363 |
| 2/61 | - 362 700 021 | Frame without sub-frame (RHD) | 1 | 362, 364 |
| 2/61 | 2 361 700 041 | Sub-frame | 1 | |
| | 3 N 14 499 1 | Stud AM 10 B×28 | 2 | |
| 7/62 | - 311 701 449 | Threaded plate – Safety belt mounting on floor plate | 2 | M 259 |
| | 4 311 705 057 | Floor plate, left (LHD) | 1 | |
| 2/61 | - 312 705 057 | Floor plate, left (RHD) | 1 | |
| | 5 311 705 058 | Floor plate, right (LHD) | 1 | |
| 2/61 | - 312 705 058 | Floor plate, right (RHD) | 1 | |
| 11/63 | - 311 705 221 | Cover plate for master cylinder | 1 | |
| 11/63 | - N 12 226 2 | Spring washer B 6 DIN 137 galvanized | 2 | |
| 11/63 | - N 10 210 1 | Bolt, hex. head M 6×10 DIN 933 galvanized ... | 2 | |
| | 6 311 705 237 | Bracket – Front axle | 2 | |
| | 7 N 12 231 1 | Spring washer A 10 DIN 137 | 4 | |
| | 8 N 11 527 1 | Washer A 10.5 DIN 125 galvanized | 4 | |
| | 9 N 10 023 2 | Bolt, hex. head M 10×45/25 DIN 70 613 galvanized | 4 | |
| | 10 311 705 243 | Spacer – Front axle mounting | 2 | |
| | 11 N 12 010 2 | Lock washer B 10 DIN 127 galvanized | 2 | |
| | 12 N 10 019 1 | Bolt, hex. head M 10×30 DIN 70 613 | 2 | |
| | 13 311 705 253 | Cover – Frame head | 1 | |
| | 14 311 705 257 | Gasket – Frame head cover | 1 | |

| Key No. | Part No. | Description | Quantity | Type and model |
|---------|---------------|--|----------|--|
| | N 12 226 2 | Spring washer B 6 DIN 137 galvanized | 2 | |
| | N 10 212 3 | Bolt, hex. head M 6×12 DIN 933 galvanized | 2 | |
| | 111 701 255 B | Guide – Gearshift rod | 1 | |
| 11/63 | 111 701 259 A | Bush – Gearshift rod guide | 1 | |
| | 111 701 263 | Retaining ring – Bush | 1 | |
| | 311 705 261 | Rubber collar, upper – Front axle | 2 | |
| | 311 705 263 | Rubber collar, lower – Front axle | 2 | |
| | 311 705 345 | Boot – Cable guide | 1 | |
| | 111 701 415 | Bolt – Battery mounting | 1 | |
| | 311 705 431 | Socket – Jack | 2 | |
| | 311 705 445 | Cover plate – Shift rod coupling | 1 | |
| | 311 705 449 | Gasket – Cover plate | 1 | |
| 7/62 | N 12 131 2 | Shake-proof washer J 3.7 DIN 6797 galvanized .. | 3 | |
| | N 11 368 1 | Tapping screw, cheese head B 3.5×13 DIN 7971 | 3 | |
| 12/63 | 311 705 453 | Runner, inner – Front seat, left | 1 | 311-314, 361-364 |
| 12/63 | – 311 705 454 | Runner, inner – Front seat, right | 1 | 311-314, 361-364 |
| | – 311 705 455 | Runner, inner – Front seat | 2 | 311-314, 361-364 up to Chassis No. April 1963 |
| | 311 705 459 | Runner, outer – Front seat | 2 | 311-314, 361-364 |
| | 311 705 481 | Kick plate | 1 | 311-314 |
| 2/61 | – 361 705 481 | Kick plate | 1 | 361-364 |
| | 111 701 535 A | Bracket for accelerator pedal on floor plate | 1 | |
| | 311 705 679 | Reinforcement plate – Sub-frame mounting, front | 1 | |
| 2/61 | 311 705 761 | Rubber washer – Reinforcement plate | 4 | |

| Key No. | Part No. | Description | Quantity | Type and model |
|---------|-------------|---|----------|----------------|
| 35 | N 10 238 3 | Bolt, hex. head M 8×15 DIN 933 galvanized | 4 | |
| 36 | N 12 008 2 | Lock washer B 8 DIN 127 galvanized | 4 | |
| 37 | N 11 526 2 | Washer B 8.4 DIN 125 high-polish galvanized ... | 4 | |
| 38 | 311 705 683 | Rubber bush – Sub-frame mounting, front | 2 | |
| 39 | N 12 010 2 | Lock washer B 10 DIN 127 galvanized | 1 | |
| 40 | N 10 252 4 | Bolt, hex. head M 10×20 DIN 933 | 1 | |
| 41 | 311 705 687 | Rubber bush – Sub-frame mounting, rear | 2 | |
| 42 | 311 705 689 | Thrust ring – Sub-frame mounting, rear | 2 | |
| 43 | 311 705 691 | Spacer sleeve – Sub-frame mounting, rear | 2 | |
| 44 | 311 705 695 | Washer – Sub-frame mounting, rear | 2 | |
| 45 | N 10 445 1 | Bolt, hex. head M 10×45 DIN 931 | 2 | |
| 46 | N 12 010 2 | Lock washer B 10 DIN 127 galvanized | 2 | |
| 47 | 311 705 901 | Weatherstrip between body and frame | 1 | |
| 48 | 111 701 625 | Tack | x | |

| Key No. | Part No. | Description | Quantity | Type and model |
|----------------|-------------|---|----------|-------------------------|
| BUMPERS | | | | |
| 7/62 | 49 | 311 707 111 Bumper, front (use 311 707 135 A/136 A up to Chassis No. 64 915) | 1 | 311-314,351,352,361-364 |
| - | 311 707 133 | Bracket – Bumper (front) up to Chassis No. 64 915 | 2 | 311-314, 361, 362 |
| 7/62 | 50 | 311 707 135 A Bracket – Bumper (front, left) from Chassis No. 64 916 | 1 | 311-314,351,352,361-364 |
| 7/62 | - | 311 707 136 A Bracket – Bumper (front, right) from Chassis No. 64 916 | 1 | 311-314,351,352,361-364 |
| 7/62 | 51 | 311 707 141 Screw M 8×40 – Bumper | 4 | 311-314,351,352,361-364 |
| 7/62 | 52 | N 11 526 2 Washer B 8.4 DIN 125 high-polish galvanized ... | 4 | 311-314,351,352,361-364 |
| 7/62 | 53 | N 12 009 1 Lock washer A 8 DIN 127 | 4 | 311-314,351,352,361-364 |
| 7/62 | 54 | N 11 008 3 Nut, hex. M 8 DIN 934 galvanized | 4 | 311-314,351,352,361-364 |
| 7/62 | 55 | 311 707 145 Reinforcement – Overrider mounting | 4 | 311-314,351,352,361-364 |
| 7/62 | 56 | N 12 009 1 Lock washer A 8 DIN 127 | 4 | 311-314,351,352,361-364 |
| 7/62 | 57 | N 10 360 2 Bolt, hex. head BM 8×60 DIN 931 galvanized ... | 4 | 311-314,351,352,361-364 |
| 7/62 | 58 | 311 707 155 A Overrider – Bumper (front left and rear right) | 2 | 311-314,351,352,361-364 |
| 7/62 | 59 | 311 707 156 A Overrider – Bumper (front right and rear left) ... | 2 | 311-314,351,352,361-364 |
| | 60 | N 14 140 1 Screw, fillister head AM 6×15 DIN 7985 galvanized | 4 | 311-314,351,352,361-364 |
| | 61 | N 12 226 2 Spring washer B 6 DIN 137 galvanized | 4 | 311-314,351,352,361-364 |
| 7/62 | 62 | N 11 006 2 Nut, hex. M 6 DIN 934 galvanized | 4 | 311-314,351,352,361-364 |
| 7/62 | 63 | 311 707 311 Bumper, rear (use 311 707 325 A/326 A up to Chassis No. 64 915) | 1 | 311-314,351,352,361-364 |

| Key No. | Part No. | Description | Quantity | Type and model |
|---------|------------------|--|----------|-------------------------|
| 8/62 | - 311 707 311 B | Bumper, rear (Italy only) (use 311 707 325 A/326 A up to Chassis No. 64 915) | 1 | M 280, 311-314, 361-364 |
| 7/62 | 64 311 707 325 A | Bracket - Bumper (rear, left) from Chassis No. 64 916 | 1 | 311-314,351,352,361-364 |
| 7/62 | - 311 707 326 A | Bracket - Bumper (rear, right) from Chassis No. 64 916 | 1 | 311-314,351,352,361-364 |
| | - 311 707 339 | Bracket - Bumper (rear) up to Chassis No. 64 915 | 2 | 311-314, 361, 362 |
| 65 | 111 821 149 A | Spring washer 8.1×22 | 8 | 311-314,351,352,361-364 |
| 66 | N 10 241 1 | Bolt, hex. head M 8×22 DIN 933 galvanized | 8 | 311-314,351,352,361-364 |